

The background features a stylized city skyline with various skyscrapers in shades of blue and red. Overlaid on this are faint architectural drawings, including floor plans and structural diagrams with labels like 'LP-3' and 'L,U'.

建筑结构与识图

承德石油高等专科学校



板内其他配筋详图





目录

1 板后浇带钢筋构造

2 板加腋构造

3 局部升降板构造

4 板开洞与洞边加强筋构造

1、板后浇带钢筋构造

贯通
钢筋
构造

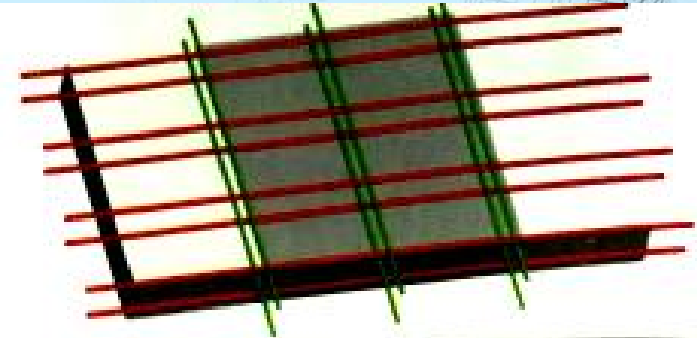
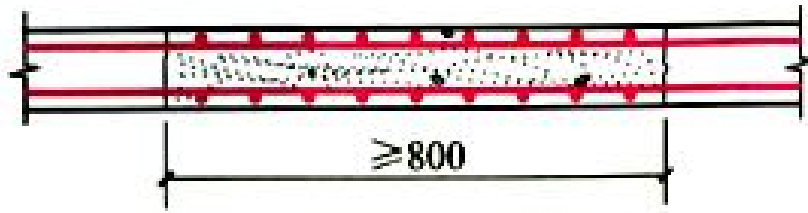

100%
搭接
钢筋
构造

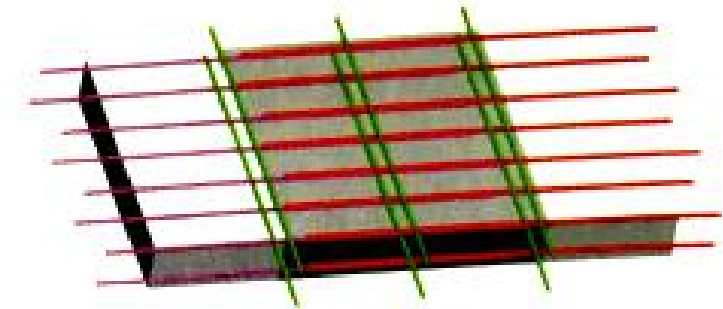
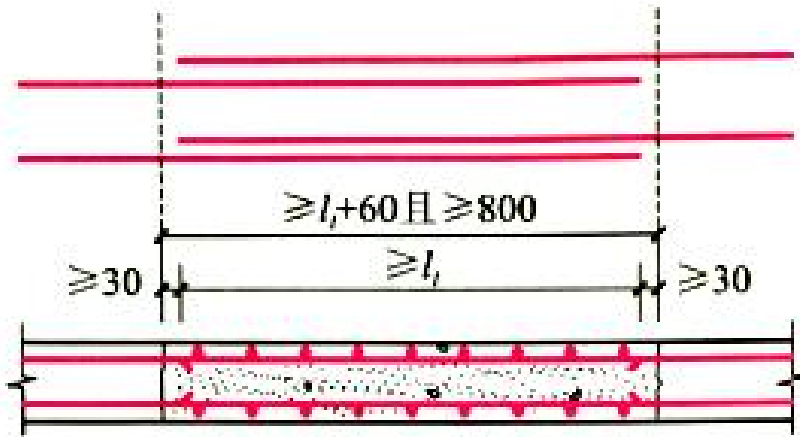

2、板加腋构造

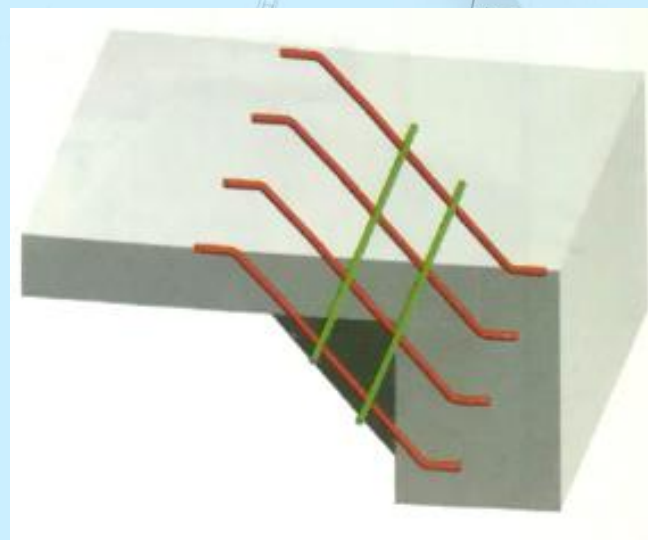
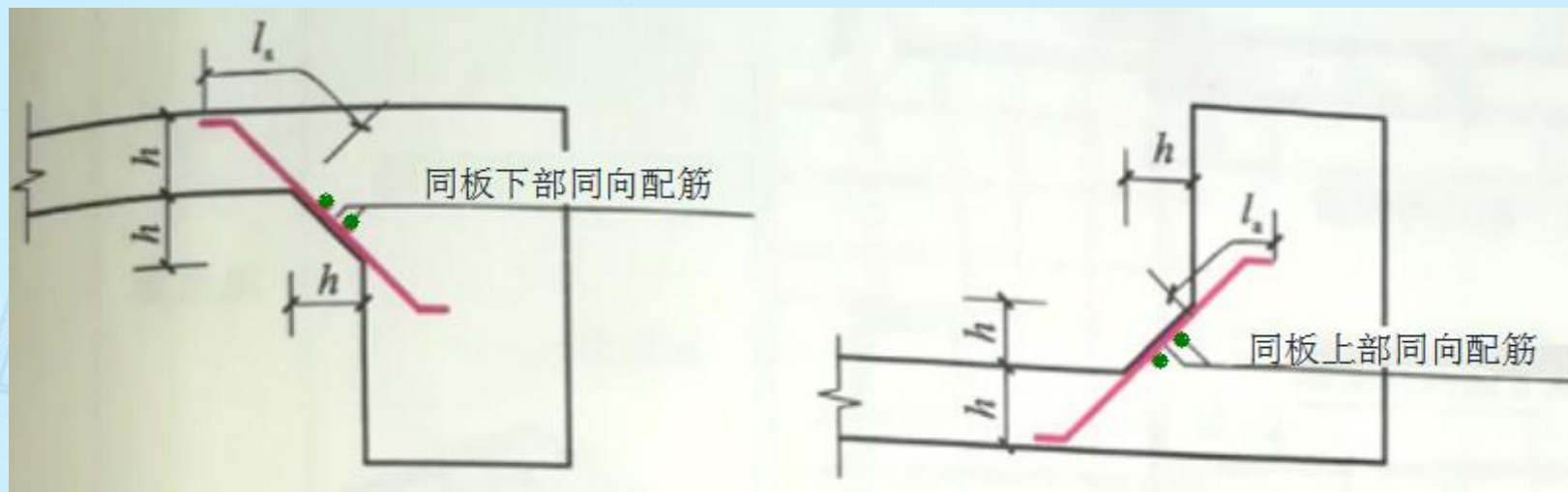

3、局部升降板构造

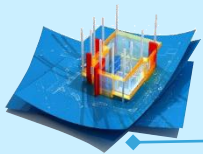

1) 构造一

板中升降

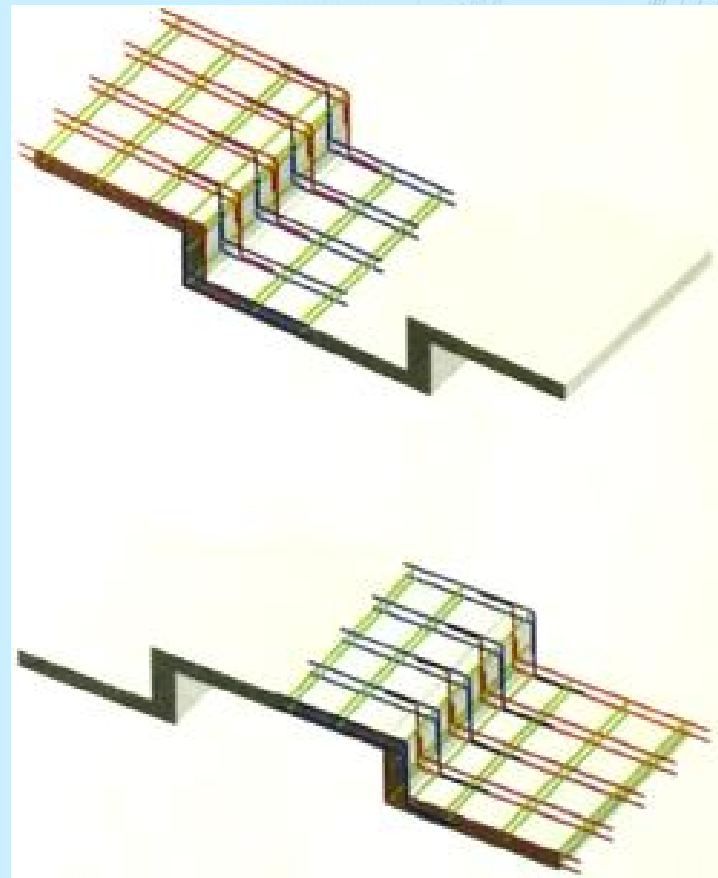
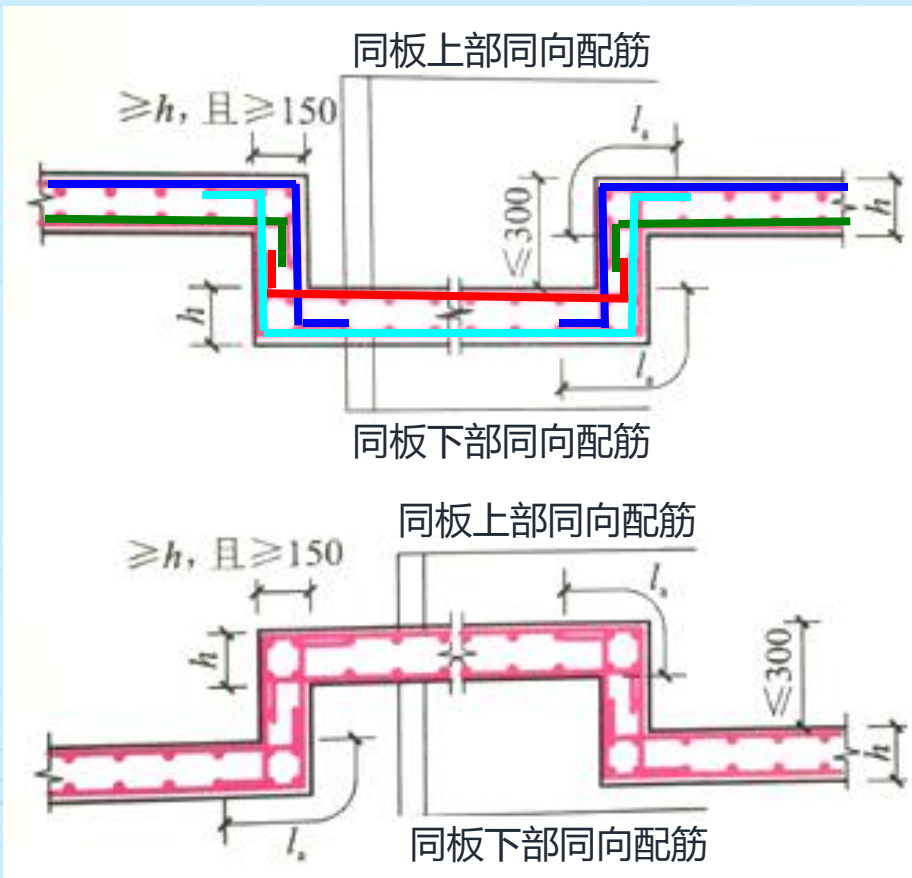

3、局部升降板构造

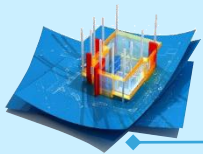

1) 构造一

侧边为梁

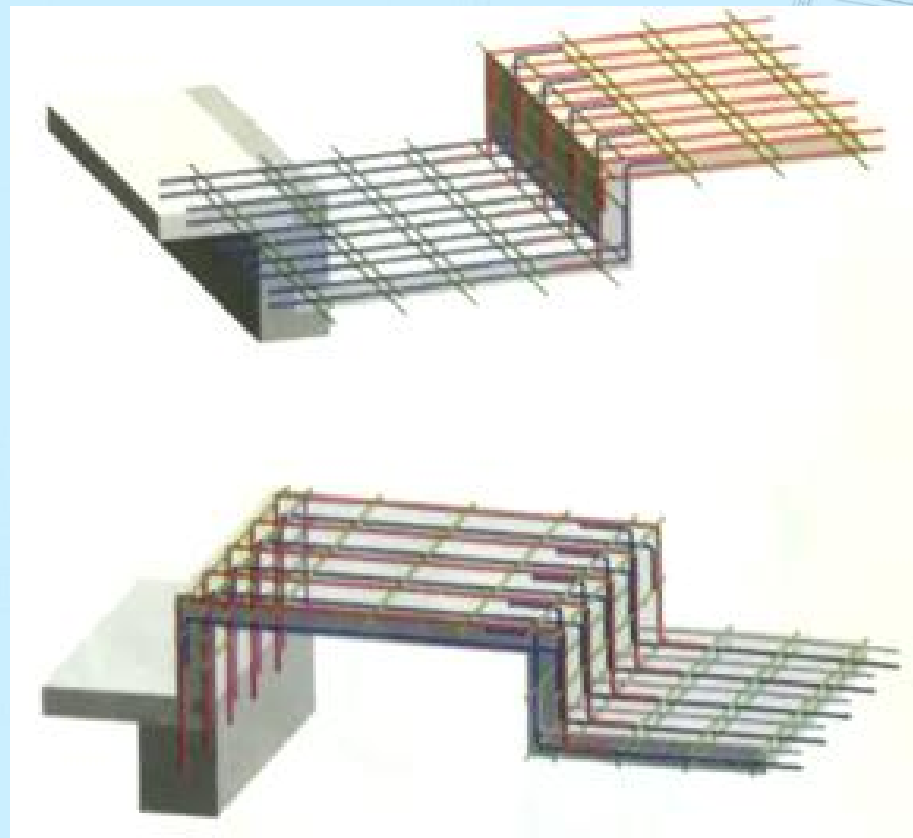
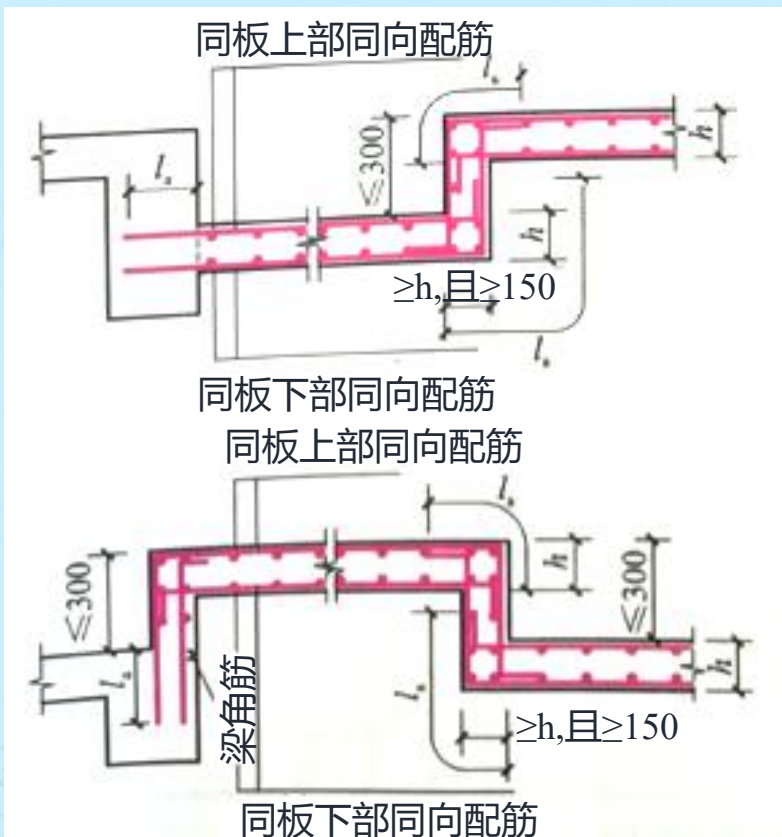

3、局部升降板构造

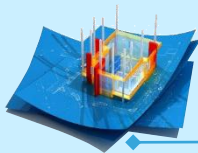

2) 构造二

板中升降

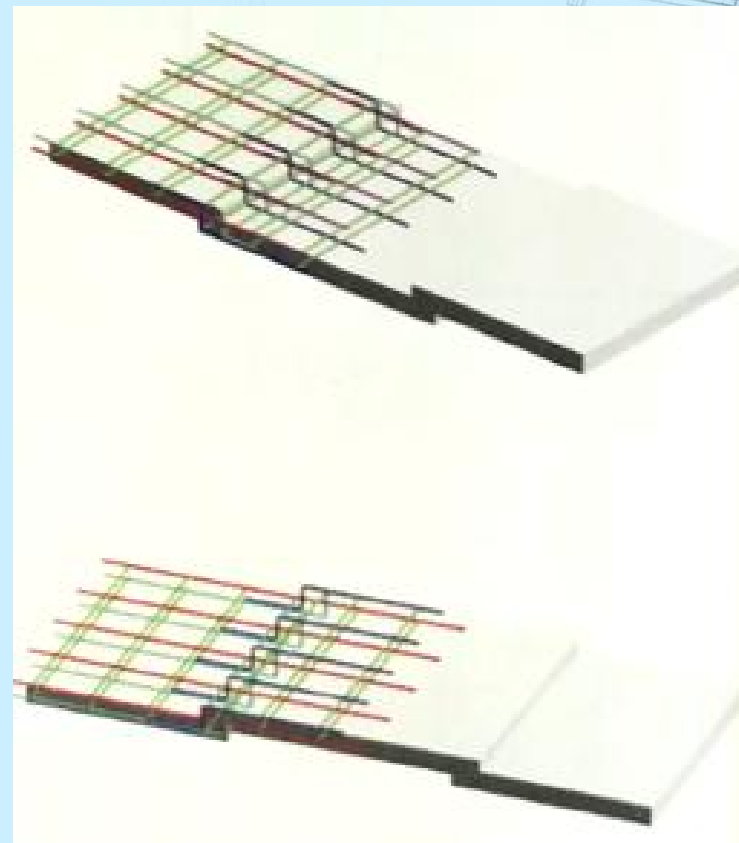
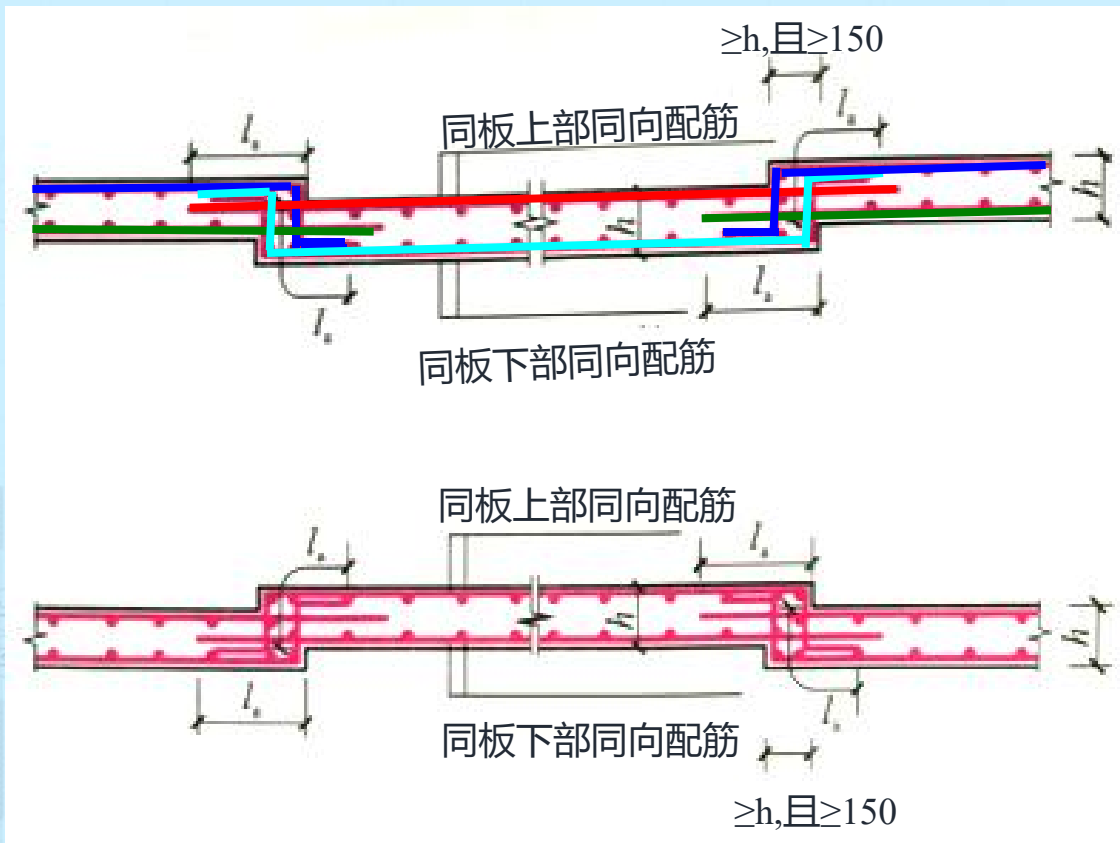

3、局部升降板构造

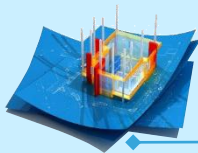

2) 构造二

板中升降

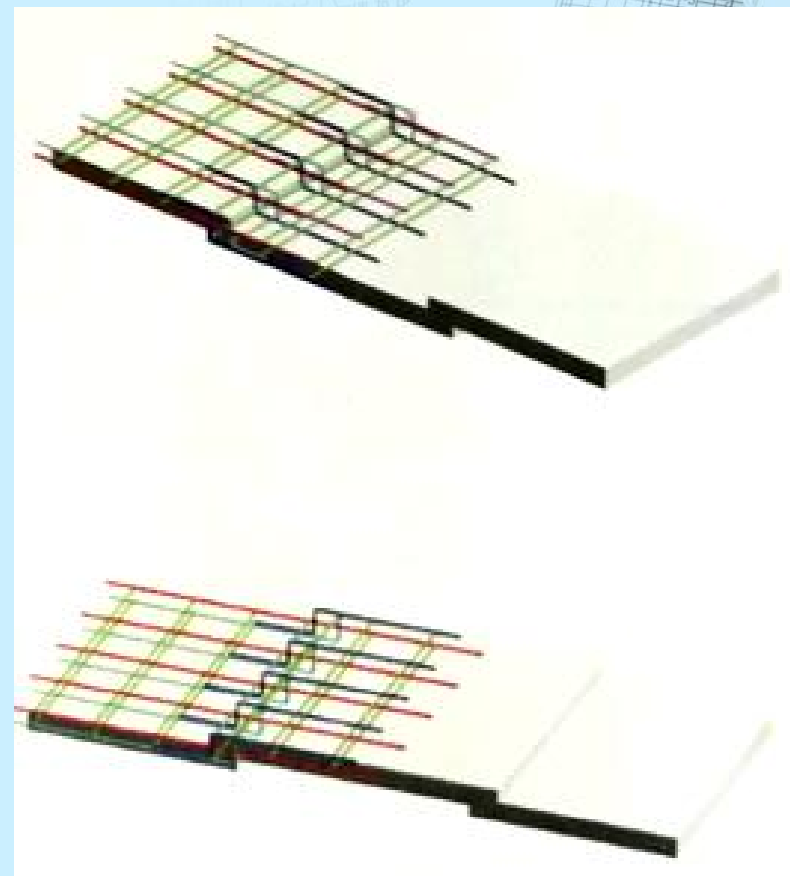
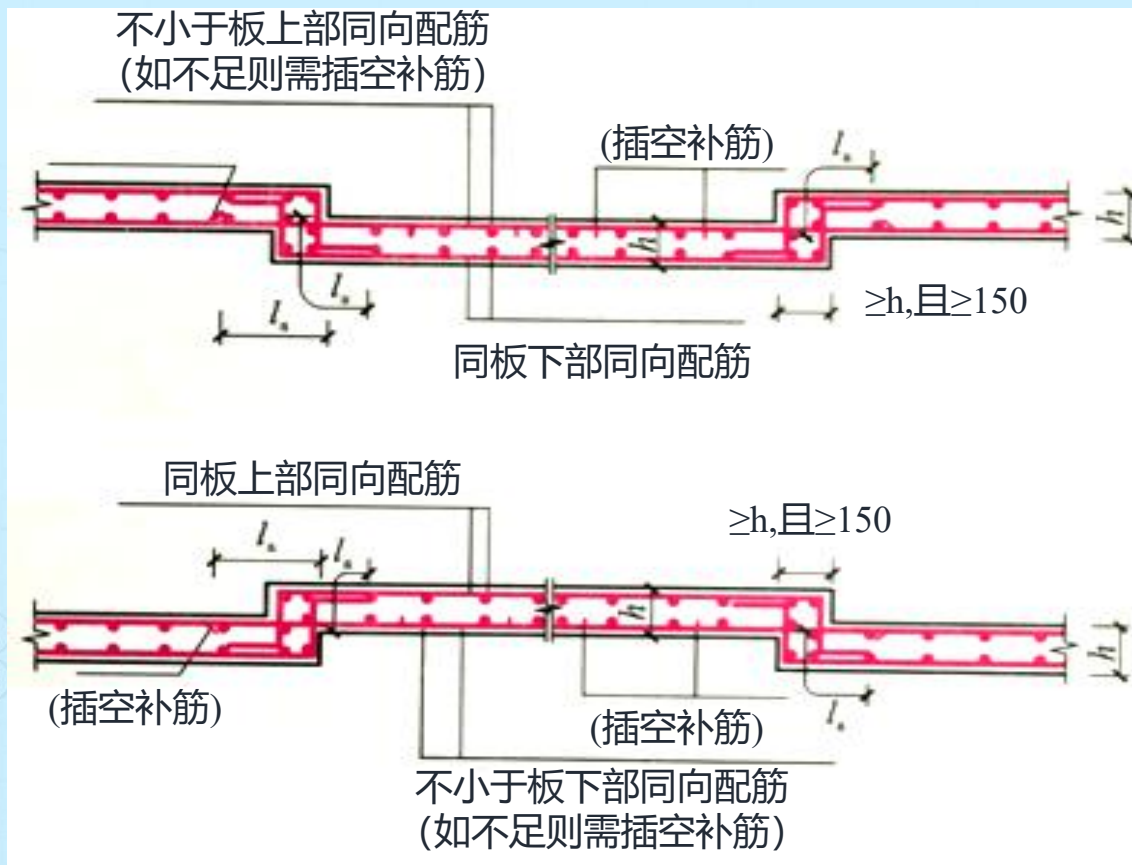

3、局部升降板构造

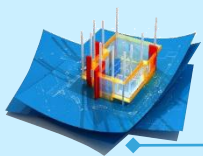

2) 构造二

侧边为梁

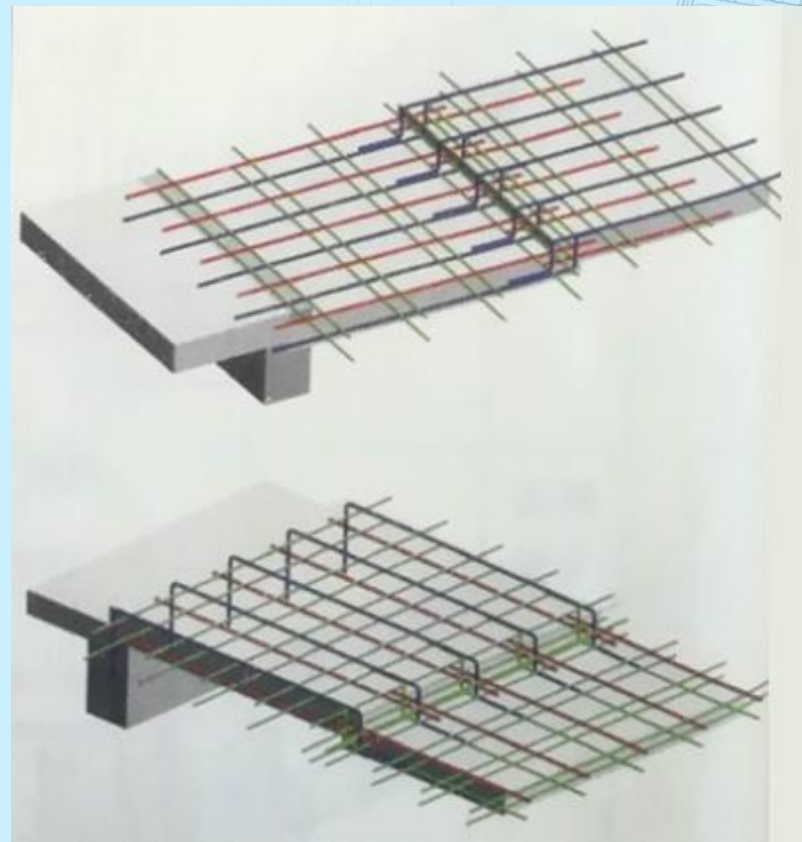
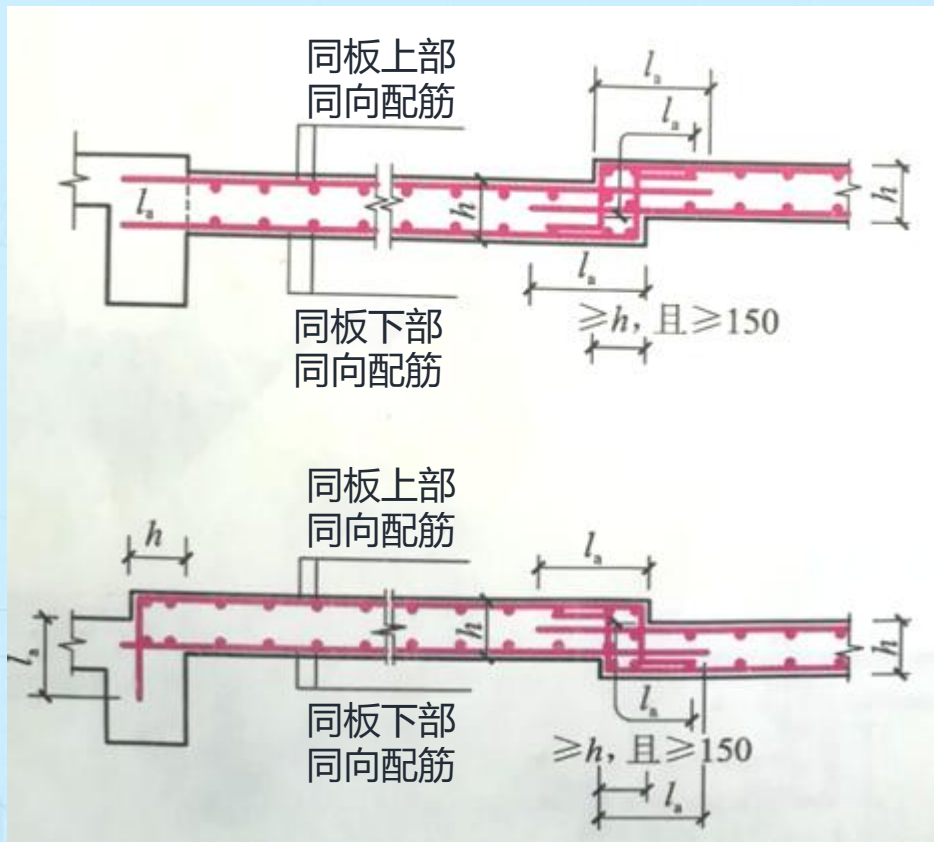

以上内容仅为本文档的试下载部分，为可阅读页数的一半内容。如要下载或阅读全文，请访问：<https://d.book118.com/20811127070006077>