



CHAPTER 75
AIR

CH-SC-SU	Schem	Page	Sheet	Date	CH-SC-SU	Schem	Page	Sheet	Date
75-EFFECTIVE PAGES									
		1		Jan 26/2012					
		2		BLANK					
75-CONTENTS									
		1		Jul 21/2009					
		2		BLANK					
75-ALPHABETICAL INDEX									
		1		Jul 21/2009					
		2		BLANK					
75-32-00		101		Jan 20/2006					
		102		Jan 20/2006					
75-32-01		101.1	1	Jan 20/2006					
			2	Jan 20/2006					
			3	Jan 20/2006					
		102	1	Jul 21/2009					
			2	Jul 21/2009					
			3	Jul 21/2009					
		103	1	Jul 21/2009					
			2	Jul 21/2009					
			3	Jul 21/2009					
		104	1	Jul 21/2009					
			2	Jul 21/2009					
			3	Jul 21/2009					

A = Added, R = Revised, D = Deleted, O = Overflow

75-EFFECTIVE PAGES



CHAPTER 75
AIR

Title	CH-SC-SU	Schem	Page	Sheet	Date	Effectivity
<u>COMPRESSOR BLEED CONTROL SYSTEM</u>						
COMPRESSOR BLEED VALVES CONTROL SYSTEM	75-32-00		101		Jan 20/2006	301-402
			102		Jan 20/2006	501-999
ENGINE BLEED VALVES CONTROL	75-32-01		101.1	1	Jan 20/2006	301-303
				2	Jan 20/2006	301-303
				3	Jan 20/2006	301-303
			102	1	Jul 21/2009	304-305
				2	Jul 21/2009	304-305
				3	Jul 21/2009	304-305
			103	1	Jul 21/2009	401-402
				2	Jul 21/2009	401-402
				3	Jul 21/2009	401-402
			104	1	Jul 21/2009	501-999
				2	Jul 21/2009	501-999
				3	Jul 21/2009	501-999

CHAPTER 75
AIR

CH-SC-SU	Title
75-32-00	COMPRESSOR BLEED VALVES CONTROL SYSTEM
75-32-01	ENGINE BLEED VALVES CONTROL

CH-SC-SU	Title
----------	-------

75-ALPHABETICAL INDEX

D280N034S

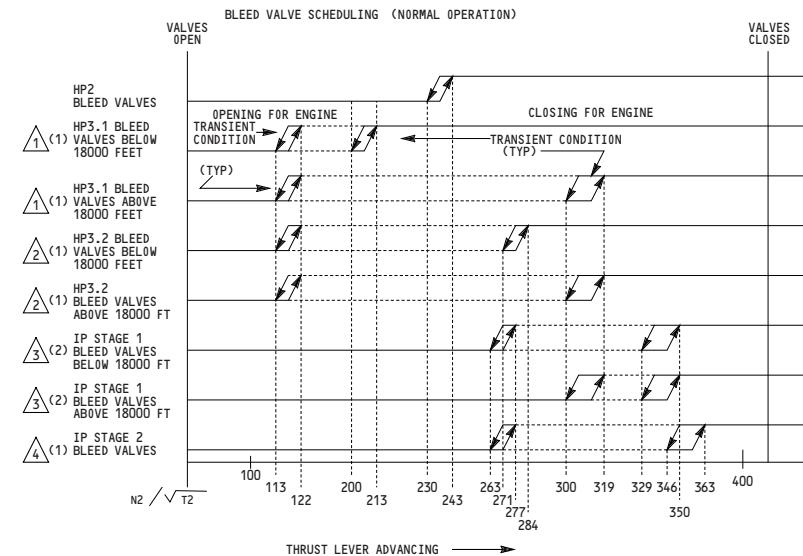
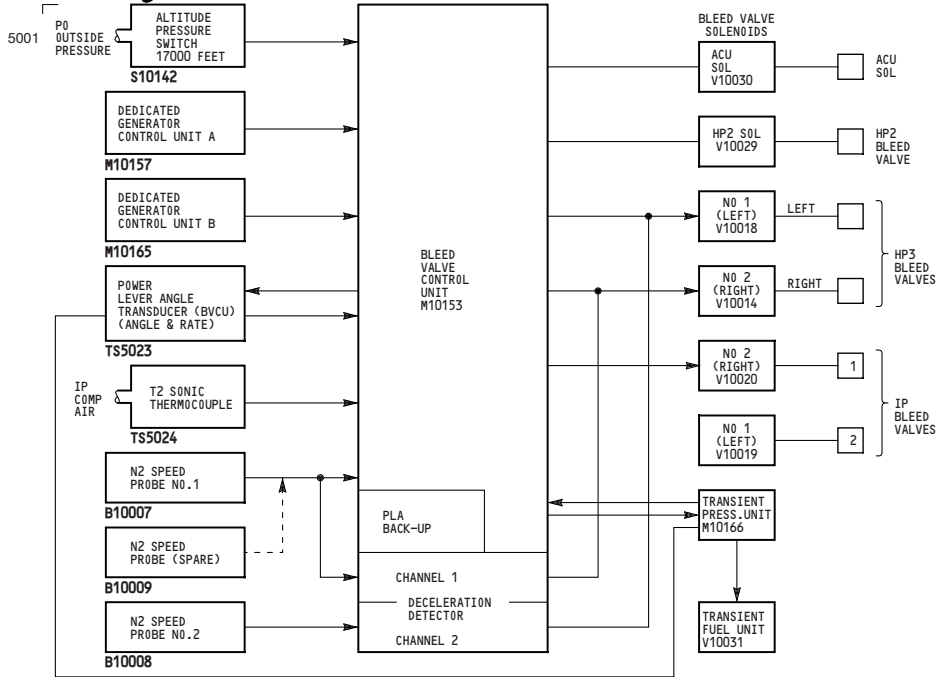

SYMBOL	BLEED VALVES	ALTITUDE	TIMER	ACTION ON BV
A	HP3S AND HP2S △1 AND △2	<18000 FT	6.5 SEC	WHEN BOTH A AND B ARE TIMED OUT CLOSE BLEED VALVES
		>18000 FT	13.0 SEC	
B	HP3S AND HP2S △1 AND △2	<18000 FT	2.5 SEC	WHEN BOTH D AND E ARE TIMED OUT CLOSE BLEED VALVES
		>18000 FT	5.0 SEC	
C	HP3S AND HP2S △1 AND △2	<18000 FT	IMMEDIATE	OPEN IMMEDIATELY
		>18000 FT	IMMEDIATE	OPEN IMMEDIATELY
D	IPS △3 & △4	<18000 FT	9.5 SEC	WHEN BOTH D AND E ARE TIMED OUT CLOSE BLEED VALVES
		>18000 FT	19.0 SEC	
E	IPS △3 & △4	<18000 FT	4.5 SEC	WHEN BOTH D AND E ARE TIMED OUT CLOSE BLEED VALVES
		>18000 FT	9.0 SEC	
F	IPS △3 & △4	<18000 FT	IMMEDIATE	OPEN IMMEDIATELY
		>18000 FT	IMMEDIATE	OPEN IMMEDIATELY

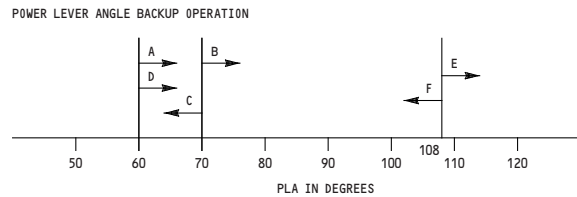

NOTES:
 △ SEE 75-32-01
 1 TRANSIENT ENGINE CONDITION EXISTS WHEN THE CHANGE IN N2/√T2 IS MORE THAN 13 UNITS AT A RATE GREATER THAN 5 UNITS/SECOND.

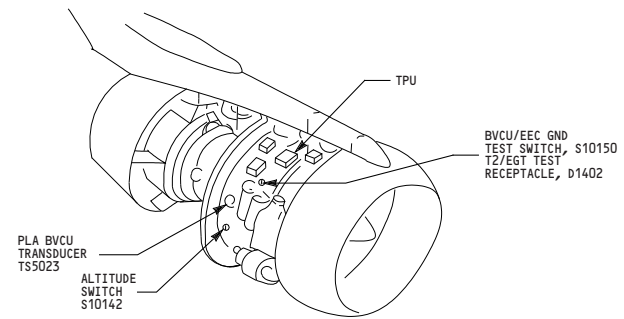

301-402

COMPRESSOR BLEED VALVES CONTROL SYSTEM

D280N034S

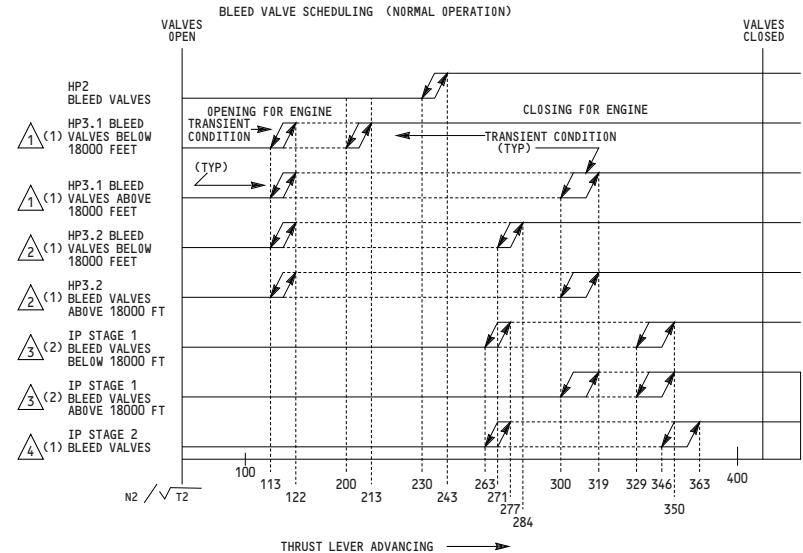
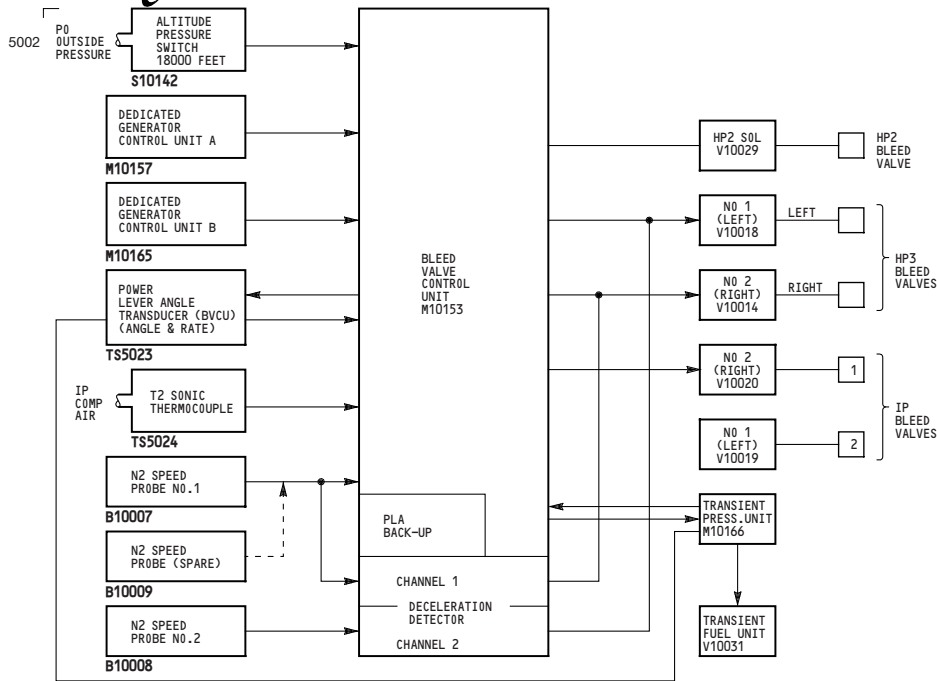

SYMBOL	BLEED VALVES	ALTITUDE	TIMER	ACTION ON BV
A	HP3S AND HP2S △1 AND △2	<18000 FT	6.5 SEC	WHEN BOTH A AND B ARE TIMED OUT, CLOSE BLEED VALVES
		>18000 FT	13.0 SEC	
B	HP3S AND HP2S △1 AND △2	<18000 FT	2.5 SEC	WHEN BOTH D AND E ARE TIMED OUT, CLOSE BLEED VALVES
		>18000 FT	5.0 SEC	
C	HP3S AND HP2S △1 AND △2	<18000 FT	IMMEDIATE	OPEN IMMEDIATELY
		>18000 FT	IMMEDIATE	OPEN IMMEDIATELY
D	IPS △3 & △4	<18000 FT	9.5 SEC	WHEN BOTH D AND E ARE TIMED OUT, CLOSE BLEED VALVES
		>18000 FT	19.0	
E	IPS △3 & △4	<18000 FT	4.5 SEC	WHEN BOTH D AND E ARE TIMED OUT, CLOSE BLEED VALVES
		>18000 FT	9.0 SEC	
F	IPS △3 & △4	<18000 FT	IMMEDIATE	OPEN IMMEDIATELY
		>18000 FT	IMMEDIATE	OPEN IMMEDIATELY

POWER LEVER ANGLE BACKUP OPERATION

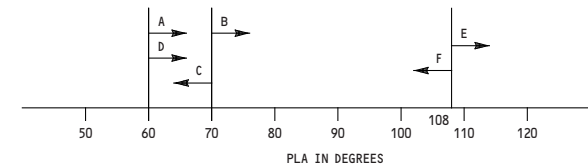

NOTES:

- △ SEE 75-32-01
- ① TRANSIENT ENGINE CONDITION EXISTS WHEN THE CHANGE IN N2/T2 IS MORE THAN 13 UNITS AT A RATE GREATER THAN 5 UNITS/SECOND.

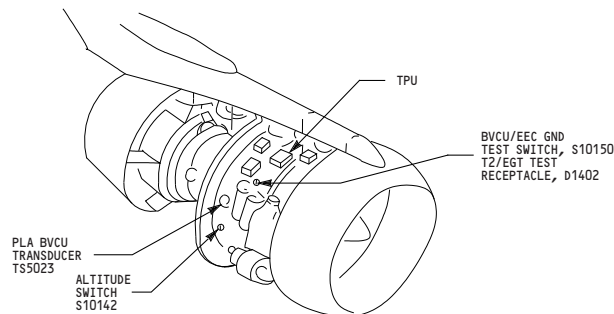

501-999

COMPRESSOR BLEED VALVES CONTROL SYSTEM

D280N034S

75-32-00

THIS PAGE INTENTIONALLY LEFT BLANK

5017

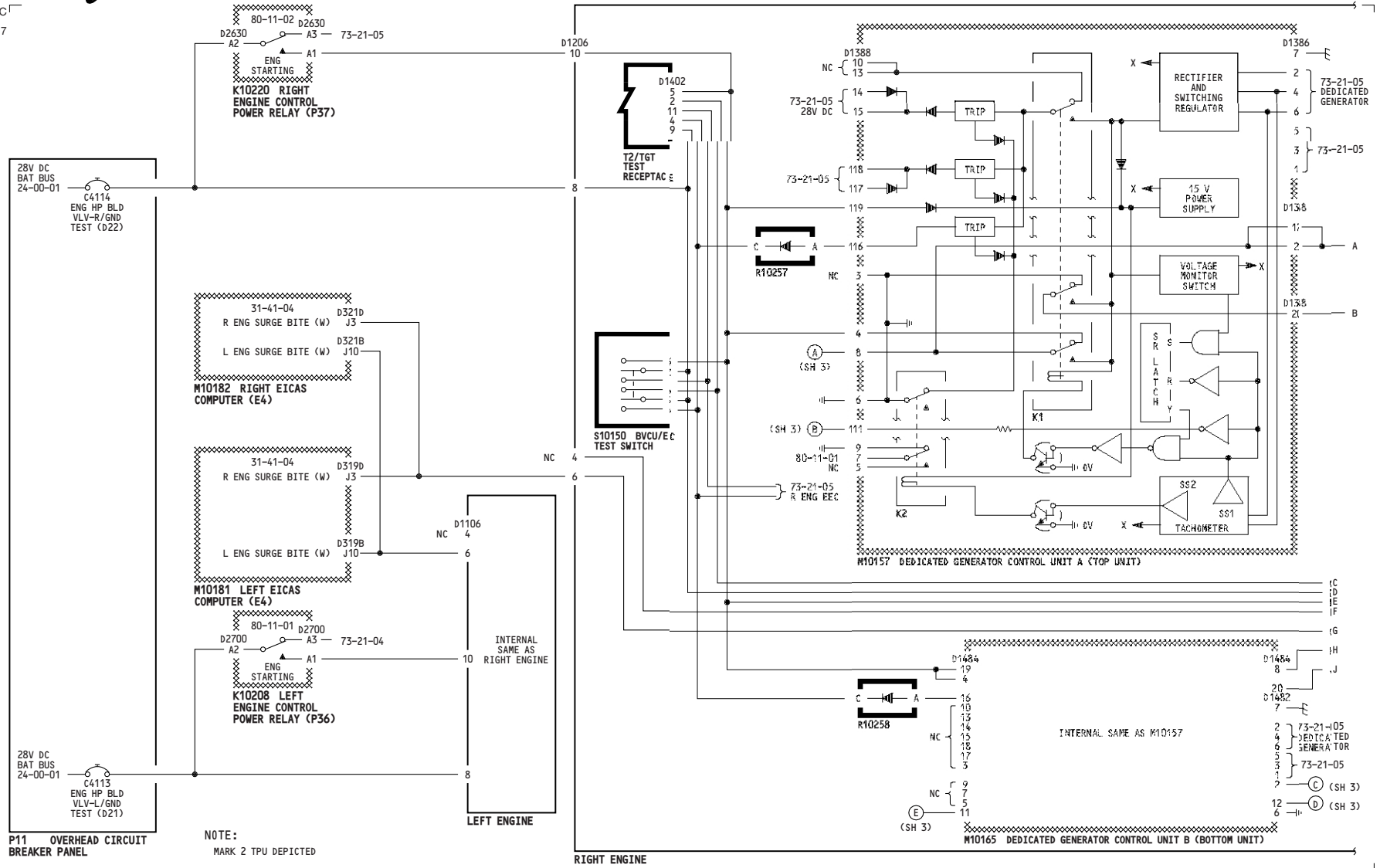

P11 OVERHEAD CIRCUIT BREAKER PANEL
NOTE:
MARK 2 TPU DEPICTED

ENGINE BLEED VALVES CONTROL

Incorporates
75-0005

D280N034S

75-32-01

Page 101.1
Sheet 1
Jan 20/2006

5013

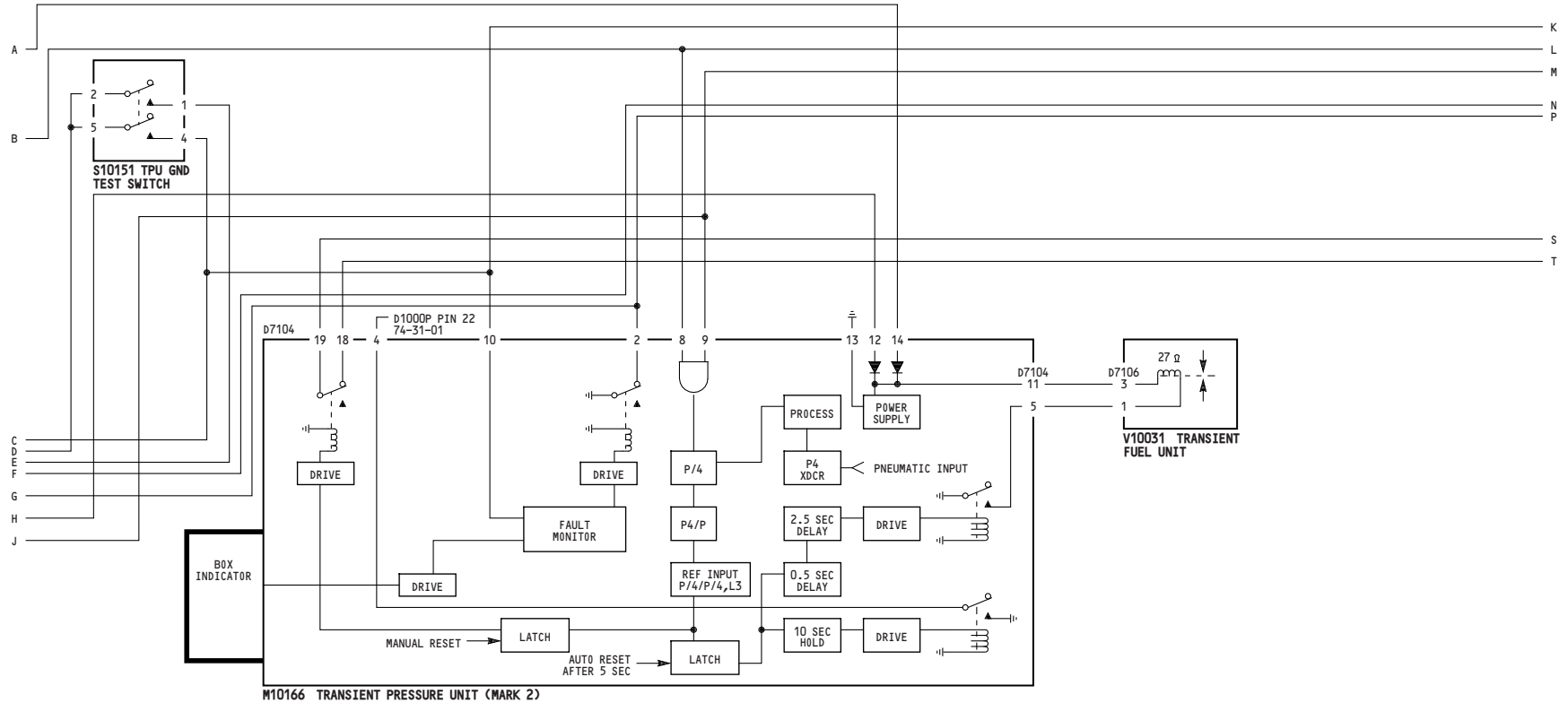

RIGHT ENGINE

NOTES: MARK 2 T.P.U. INSTALLATION DEPICTED

301-303	<p align="center">ENGINE BLEED VALVES CONTROL</p> <p align="center">D280N034S</p>
---------	--

75-32-01

Page 101.1
Sheet 2
Jan 20/2006

5013

WIRING DIAGRAMS
71-51-11
75-31-11

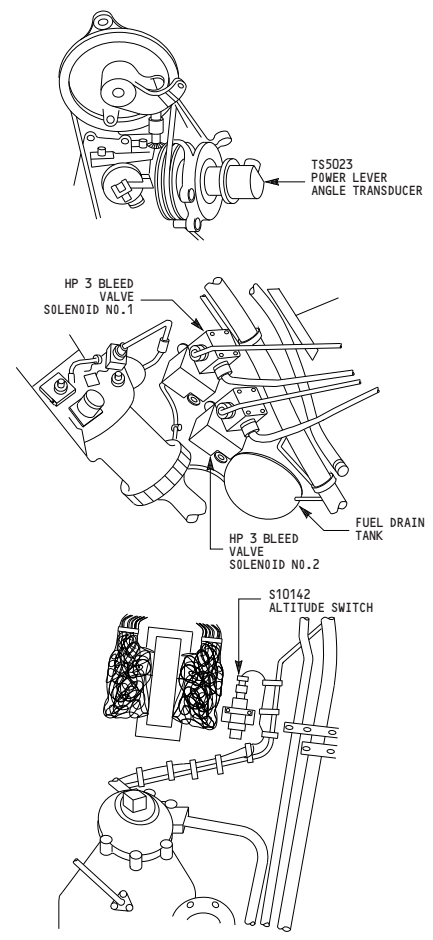
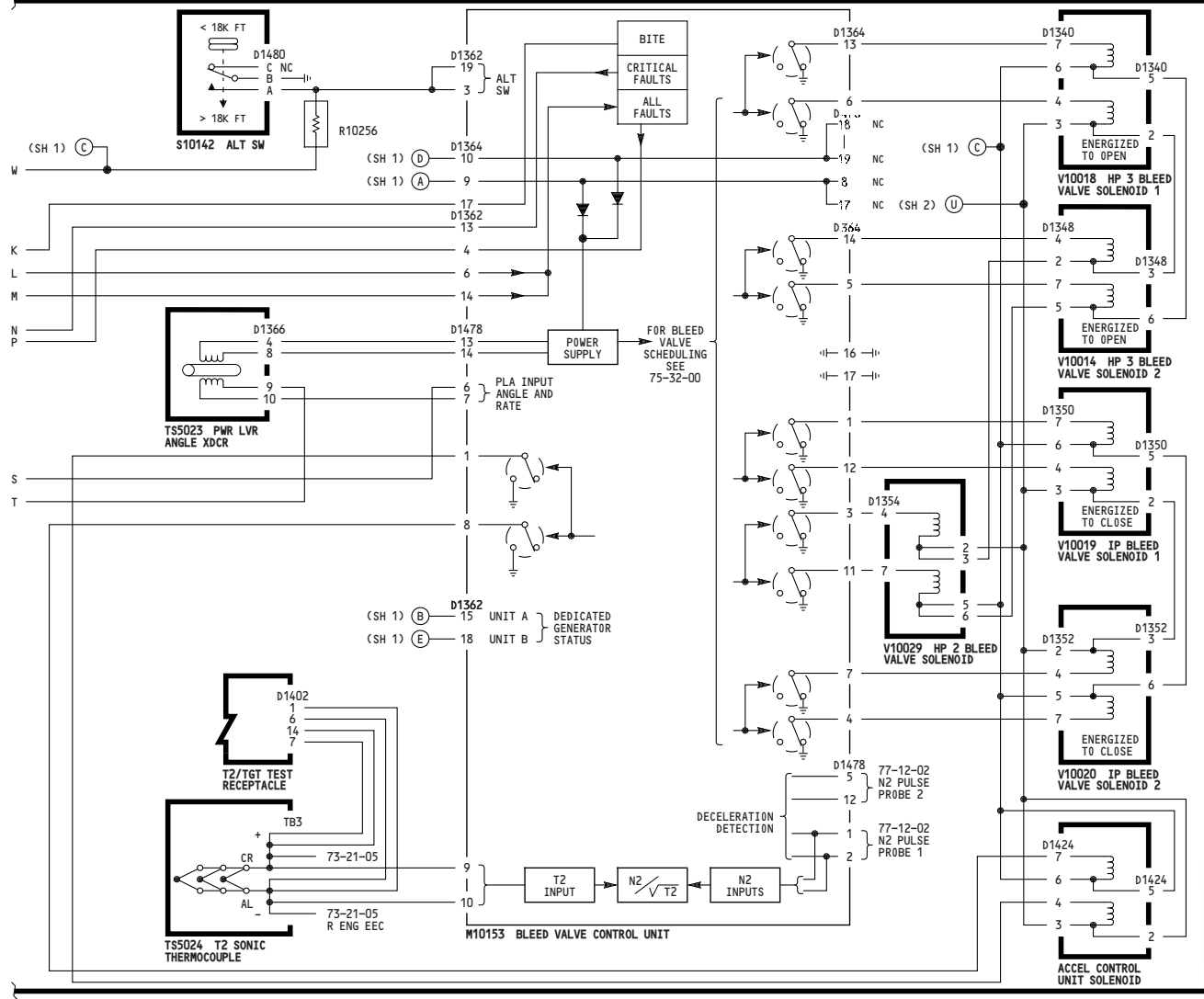

NOTES: MARK 2 T.P.U. INSTALLATION DEPICTED

RIGHT ENGINE

301-303

ENGINE BLEED VALVES CONTROL

D280N034S

75-32-01

Page 101.1
Sheet 3
Jan 20/2006

THIS PAGE INTENTIONALLY LEFT BLANK

5017

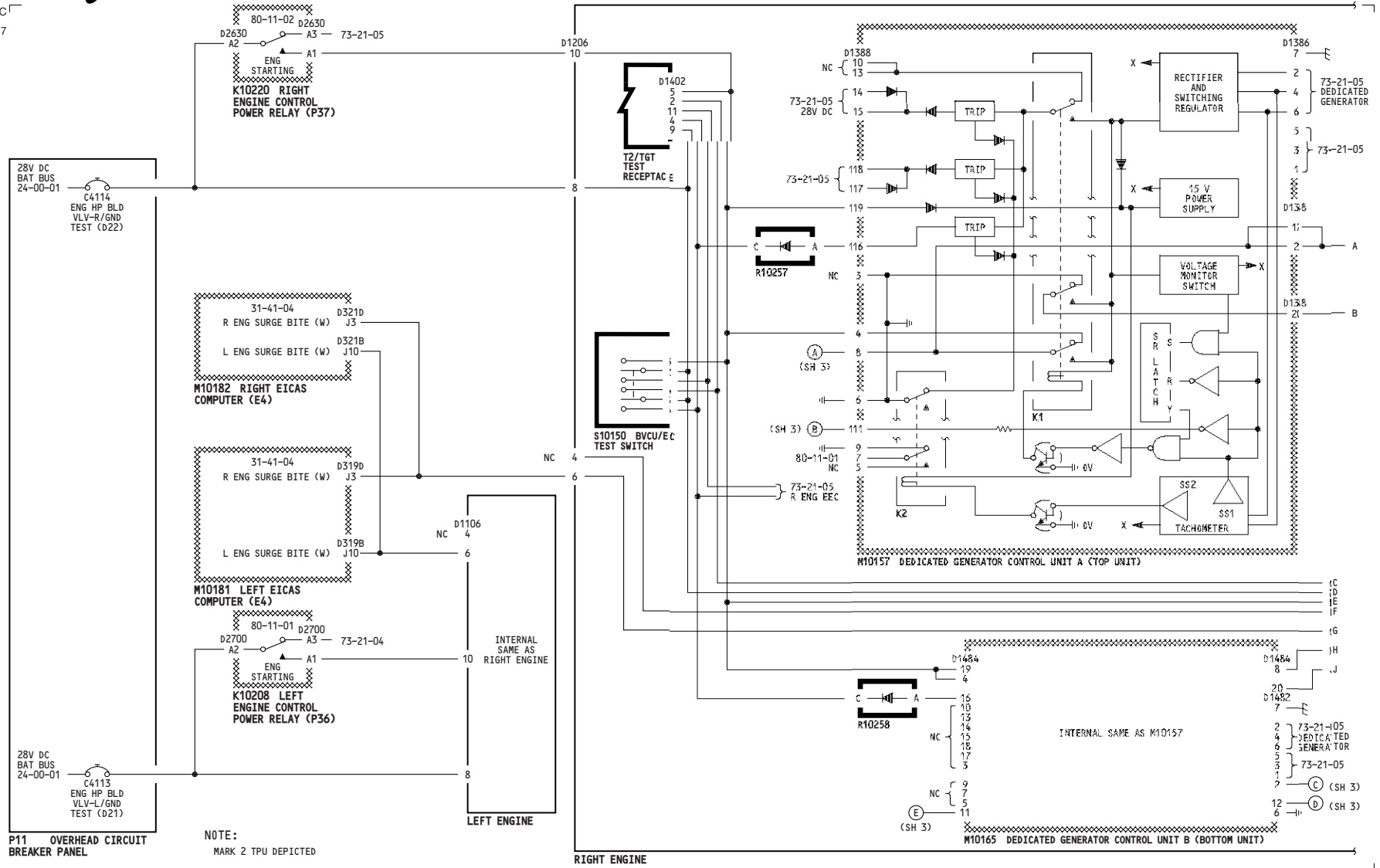

NOTE:
MARK 2 TPU DEPICTED

304-305	<p>ENGINE BLEED VALVES CONTROL</p> <p>D280N034S</p>
---------	--

75-32-01

5013

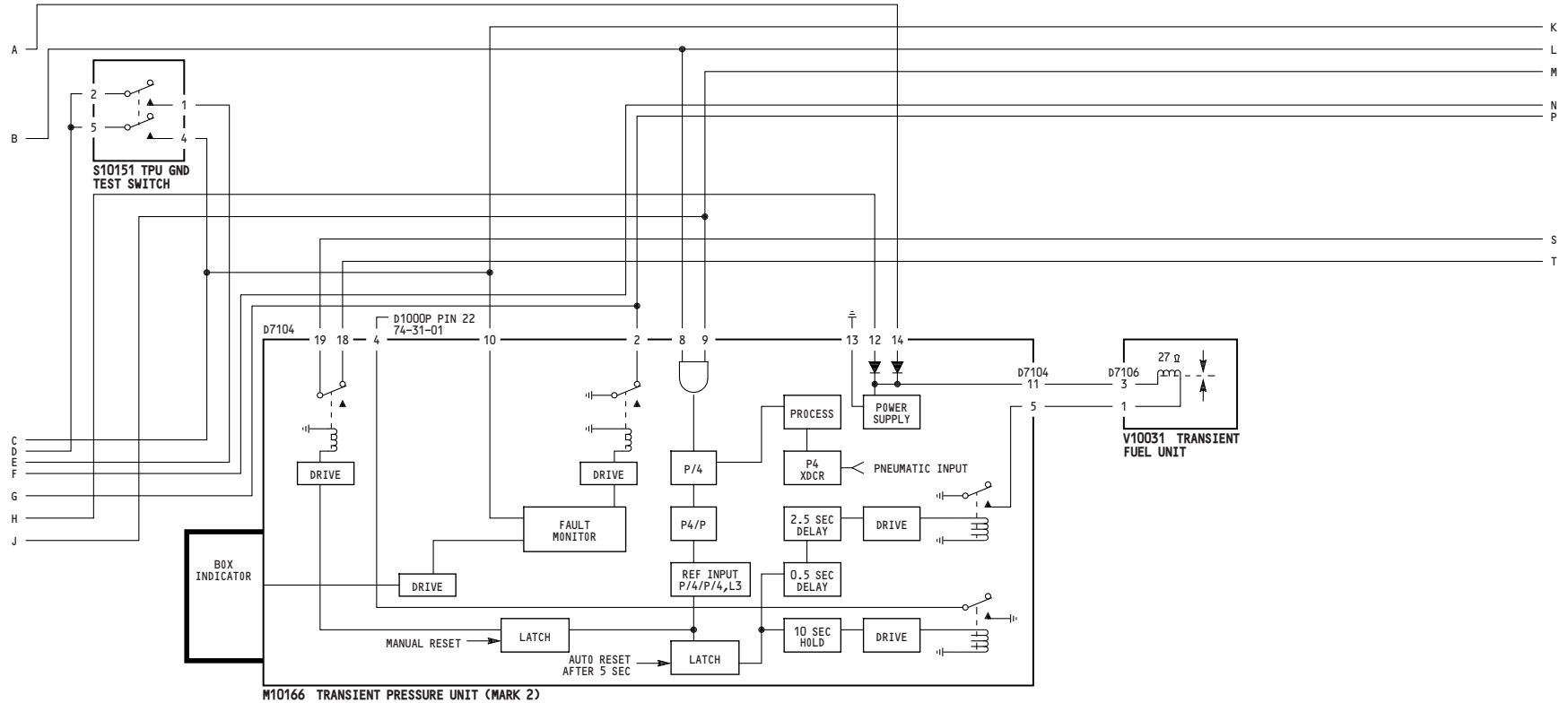

RIGHT ENGINE

NOTES: MARK 2 T.P.U. INSTALLATION DEPICTED

304-305

ENGINE BLEED VALVES CONTROL

D280N034S

75-32-01

Page 102
Sheet 2
Jul 21/2009

5027

WIRING DIAGRAMS
71-51-22
75-31-11

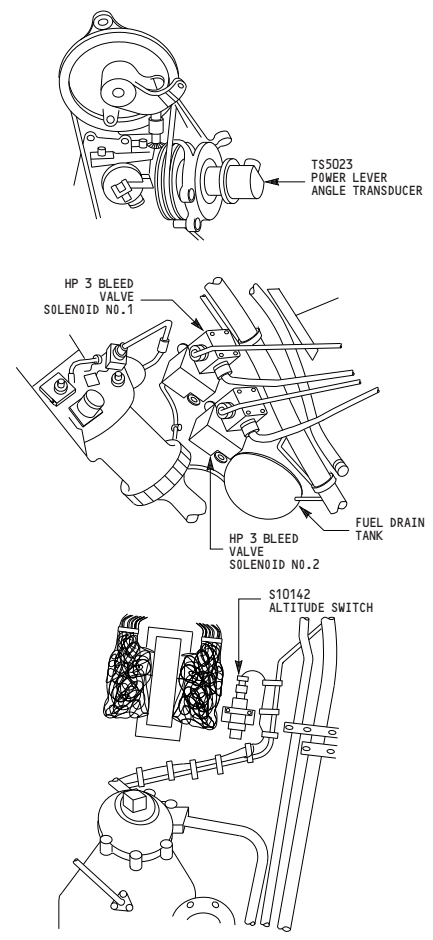
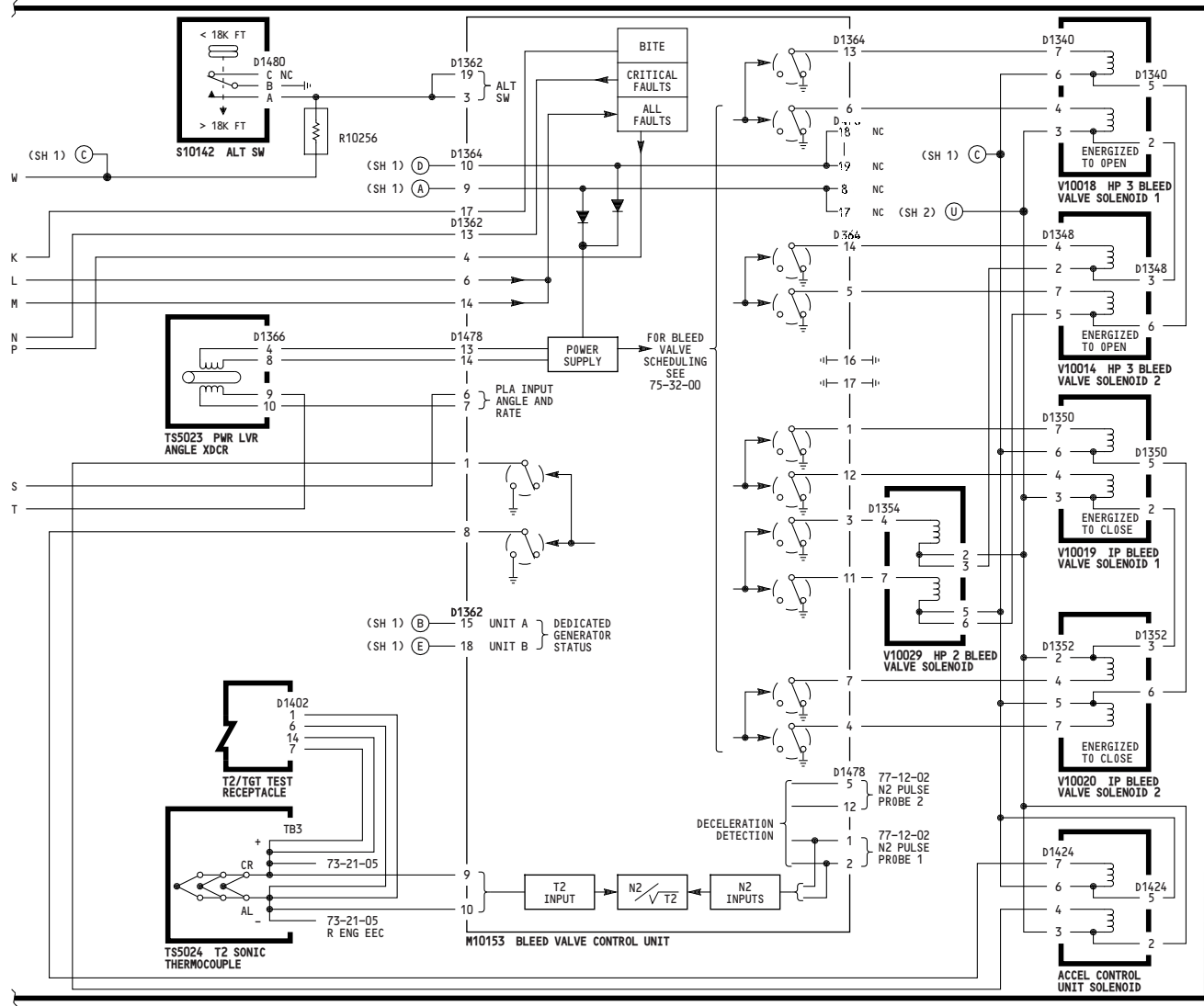

NOTES: MARK 2 T.P.U. INSTALLATION DEPICTED

RIGHT ENGINE

304-305

ENGINE BLEED VALVES CONTROL

D280N034S

75-32-01

Page 102
Sheet 3
Jul 21/2009

THIS PAGE INTENTIONALLY LEFT BLANK

以上内容仅为本文档的试下载部分，为可阅读页数的一半内容。如要下载或阅读全文，请访问：<https://d.book118.com/837034154133006136>